

NOTES:  
1. SUBSTRATE:  
FUSED SILICA

2. COATING (APPLY ACROSS CLEAR APERTURE)

S1: Ravg >98% @ 340 - 488nm (0°, All Polarizations)  
Ravg >98% @ 320 - 450nm (45°, All Polarizations)  
Ravg >99% @ 320 - 450nm (45°, S-Polarization)  
S2: NONE

3. FINE GRIND SURFACE

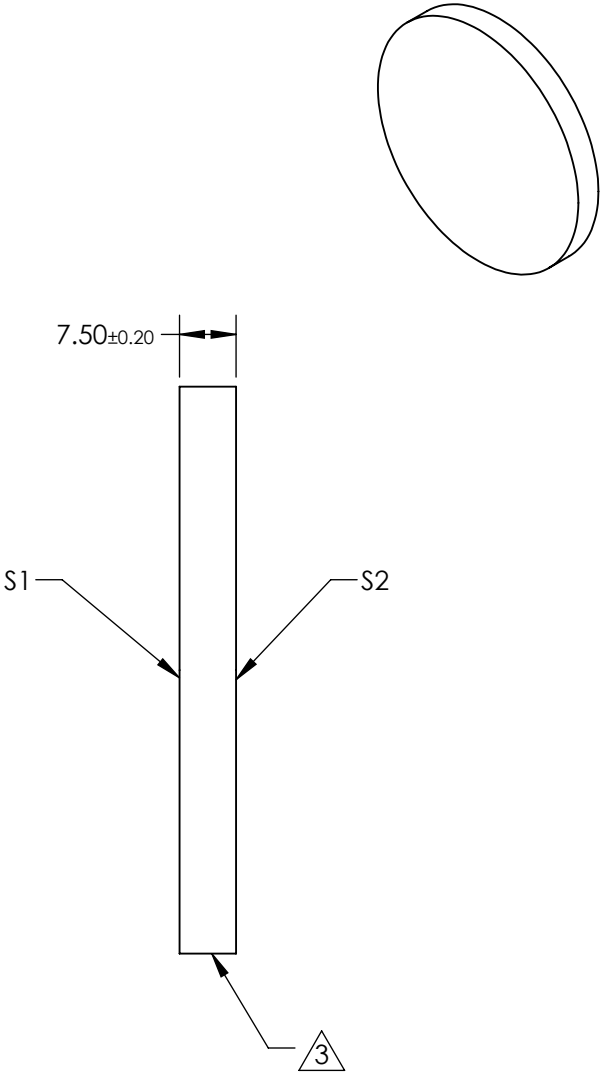
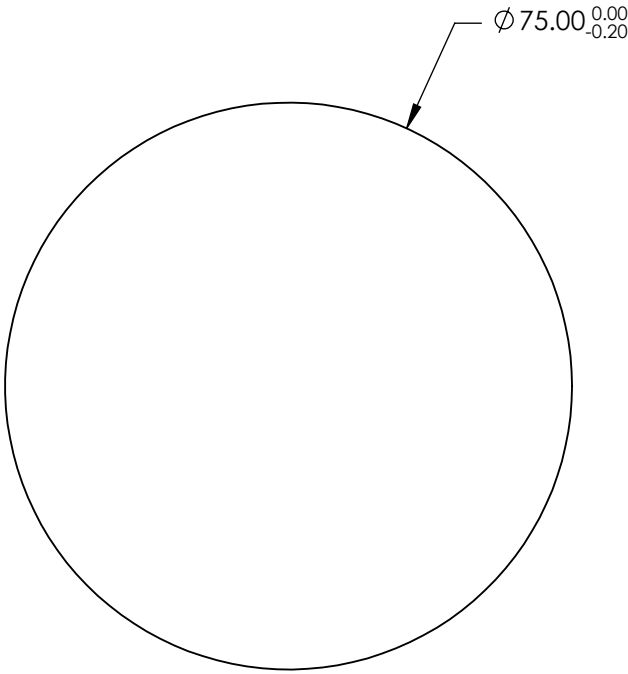

**FOR INFORMATION ONLY:  
DO NOT MANUFACTURE  
PARTS TO THIS DRAWING**

SPECIFICATIONS SUBJECT TO CHANGE WITHOUT NOTICE  
DIMENSIONS ARE FOR REFERENCE ONLY

	S1	S2
SHAPE	PLANO	PLANO
CLEAR APERTURE	Ø 67.5	N/A
SURFACE QUALITY	20-10	COMMERCIAL POLISH
SURFACE FLATNESS	λ/10 (BEFORE COATING)	N/A
BEVEL	PROTECTED AS NEEDED	PROTECTED AS NEEDED

THIRD ANGLE  
PROJECTION

ALL DIMS IN      mm

Edmund Optics®

TITLE	75mm Dia. 320 - 450nm Broadband λ/10 Mirror	
DWG NO	24045	SHEET 1 OF 3